

F&V TRANSPORT AND LINE SERVICES  
CREW MEMBER TRANSPORTATION LOGISTICS  
SERVICES IN SAN JUAN, PUERTO RICO

**OPERATIONAL PLAN**



# TABLE OF CONTENTS

CONTACT LIST	1
TRANSPORTATION COMPANY INFORMATION	3
PORT INFORMATION	6
AIRPORT INFORMATION	13
HOTEL INFORMATION	25
PIER ARRIVAL PROCEDURE & SHIP DEPARTURE PROCEDURE	29

# CONTACT LIST

## **Port Information**

Puerto Rico Port Authority  
Pan American Piers East (#1) and West (#2)  
Isla Grande Santurce, Puerto Rico  
(787)729-8724  
[www.prpa.gobierno.pr](http://www.prpa.gobierno.pr)

Puerto Rico Port Authority  
Pier # 3 (In Transit Ships)  
Old San Juan, Puerto Rico  
(787)729-8724  
[www.prpa.gobierno.pr](http://www.prpa.gobierno.pr)

## **Airport Information**

Luis Munoz Marin International Airport  
Airport Code: SJU  
(787)791-0274  
[www.prps.gobierno.pr](http://www.prps.gobierno.pr)

## **Hotel Information**

Verdanza Hotel  
8020 Tartak Street  
Isla Verde Carolina, Puerto Rico  
(787)253-9000  
[www.verdanzahotel.com](http://www.verdanzahotel.com)

## **SJU Crew Transportation**

Contact : Francisco Pena Bastard/President  
Cellular PH: (787)447-2760  
Office PH: (787)647-4948  
Office Fax: (787)998-4748  
Email: [francomar3903@yahoo.com](mailto:francomar3903@yahoo.com)  
[fvtransport@gmail.com](mailto:fvtransport@gmail.com)  
Address: Quintas del Rio  
Plaza 5 B-2  
Bayamon, PR 00961

Alternate Contact: Janice Dario/Operations Coordinator  
Cellular PH: (939)265-9900  
Office PH: (787)647-4948  
Office Fax: (787)988-4748  
Email: [francomar3903@yahoo.com](mailto:francomar3903@yahoo.com)  
[fvtransport@gmail.com](mailto:fvtransport@gmail.com)

## **SJU Port Agent**

Contact: Daniel Threadgill/Operations Manager  
Cellular PH: (787)565-0924  
Office PH: (787)725-2532  
Office Fax: (787)724-0339  
Email: [operations@continentalshipping.com](mailto:operations@continentalshipping.com)  
[continental@coqui.net](mailto:continental@coqui.net)  
Address: 360 San Francisco Street  
San Juan, PR 00901

Alternate Contact: Jose Ubinas/Port Agent Supervisor  
Cellular PH: (787)565-0923  
Office PH: (787)725-2532  
Office Fax: (787)724-0339  
Email: [operations@continentalshipping.com](mailto:operations@continentalshipping.com)  
[continental@coqui.net](mailto:continental@coqui.net)

# TRANSPORTATION COMPANY INFORMATION

## General Information

Name: F&V Transport and Line Services  
Address: Quintas del Rio  
Plaza 5 B-2  
Bayamon, Puerto Rico

Contact: Francisco Pena Bastard  
PH: (787)447-2760  
Office PH: (787)647-4948  
Fax PH: (787)988-4748  
Email: [francomar3903@yahoo.com](mailto:francomar3903@yahoo.com)  
[fvtransport@gmail.com](mailto:fvtransport@gmail.com)

F & V Transport and Line Services coordinates one-way and/or roundtrip transfer from San Juan Airport to any place in Puerto Rico. It is our goal to offer the most reliable transportation service, with comfort and class, including services to and from hotels in the San Juan area and the piers.

The transportation service is insured, and it is authorized by the pertinent agencies of the Commonwealth of Puerto Rico.

In view of the importance of the tourism sector for Puerto Rico, it is essential to simplify and facilitate services, including transportation, for the employees working in this sector. In this sense, F & V Services commits to arrange and coordinate transportation for the cruise ship employees and crew members.

Uniform Attire:	Shirts:	Light Blue – Royal Blue
	Pants:	Navy Blue – Charcoal Gray

# F&V TRANSPORT AND LINE SERVICES

## Uniform Attire



**Light Blue/Navy Blue**

**Royal Blue/Navy Blue**

# Fleet



# PORT INFORMATION

## General Port Information

Name: Puerto Rico Port Authority(PRPA)

Address: Pan American Piers East and West  
Isla Grande Santurce, Puerto Rico

PH: (787)729-8724

Website: [www.prpa.gobierno.pr](http://www.prpa.gobierno.pr)

Directions: **From Luis Munoz Marin International Airport**

Start out going southeast on Jose Tony Santana Ave. toward PR-190. Turn right onto PR-190. Take the PR-26 W ramp. Merge into PR-26/Baldorioty de Castro Highway. PR-26/Baldorioty de Castro Highway becomes PR-25 N. Turn slight left onto Juan Ponce De Leon Ave./PR-25. Take this road down to the entrance of the Pan American Piers.

### **From Verdanza Hotel**

Exit the hotel to the right . Turn right onto PR-190. Take the PR-26 W ramp. Merge into PR-26/Baldorioty de Castro Highway. PR-26/Baldorioty de Castro Highway becomes PR-25 N. Turn slight left onto Juan Ponce De Leon Ave./PR-25. Take this road down to the entrance of the Pan American Piers.



# PAN AMERICAN PIER # 1 & # 2



# Map

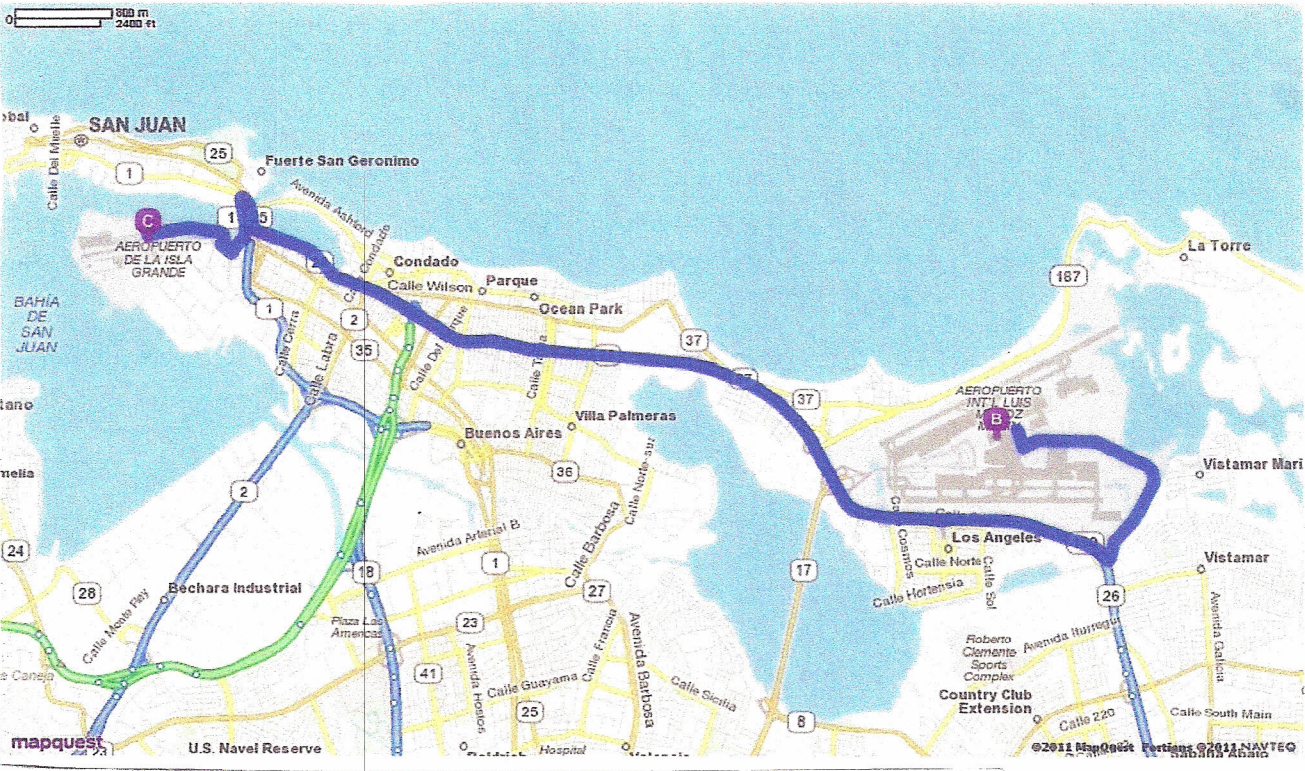

# TERMINAL DIAGRAMS

## RCCL – PAN AMERICAN ONE – SAN JUAN, PR

### FIRST FLOOR

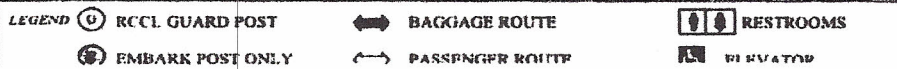
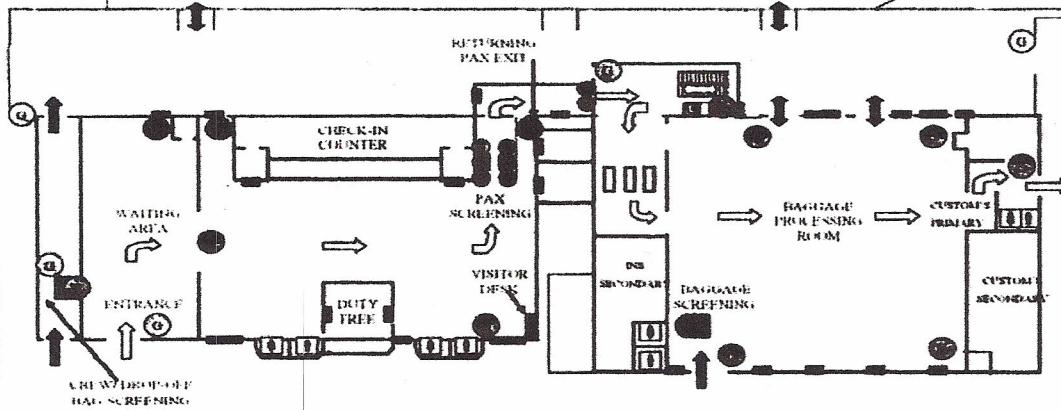

## RCCL – PAN AMERICAN 2 – SAN JUAN, PR

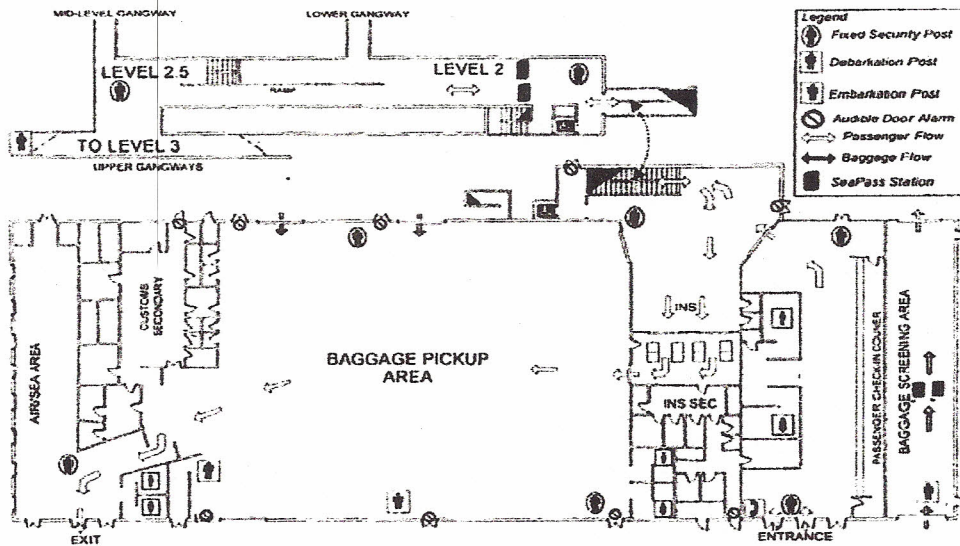

Name: Puerto Rico Port Authority(PRPA)

Address: Pier # 3 ( In Transit Ships)  
Old San Juan, Puerto Rico

PH: (787)729-8724

Website: [www.prpa.gobierno.pr](http://www.prpa.gobierno.pr)

Directions: **From Luis Munoz Marin International Airport**

Start out going southeast on Jose Tony Santana Ave. toward PR-190. Turn right onto PR-190. Take the PR-26 W ramp. Merge into PR-26/Baldorioty de Castro Highway. PR-26/Baldorioty de Castro Highway becomes PR-25 N. Turn slight left onto PR-1 N/ Manuel Fernandez Juncos Ave.

Manuel Fernandez Juncos Ave. becomes Villa Verde St. Turn right onto Lindbergh St. Turn right onto Gilberto Concepcion de Garcia St. Pier # 3 is at your right hand side.

**From Verdanza Hotel**

Exit the hotel to the right .Turn right onto PR-190. Take the PR-26 W ramp. Merge into PR-26/Baldorioty de Castro Highway. PR-26/Baldorioty de Castro Highway becomes PR-25 N. Turn slight left onto Juan Ponce De Leon Ave./PR-25. Turn slight left onto PR-1 N/ Manuel Fernandez Juncos Ave.

Manuel Fernandez Juncos Ave. becomes Villa Verde St. Turn right onto Lindbergh St. Turn right onto Gilberto Concepcion de Garcia St. Pier # 3 is at your right hand side.

## PIER # 3 (IN TRANSIT SHIPS)



# Map



# AIRPORT INFORMATION

## General Airport Information

Airport:	Luis Munoz Marin International
Distance to Verdanza Hotel:	½ mile
Travel Time:	5 minutes
Distance to Pan American Piers:	7 miles
Travel Time:	15 to 20 minutes
Distance to Pier # 3:	7 miles
Travel Time:	15 to 20 minutes

### Meet & Greet Locations

#### **Terminal B**

US Airways - Delta Airlines – United Airlines – AirTran Airways  
Baggage Claims

Upon arrival at the airport , please proceed through the entry formalities and claim your luggage. An F&V Transport Representative holding a RCCL & CC Crewmember Transportation Sign will greet you in the baggage claim terminal. Should you have any questions or concerns please contact F&V Transport at (787)647-4948.

#### **Terminal C**

JetBlue Airways-Continental Airlines-Spirit Airlines  
Baggage Claims

Upon arrival at the airport , please proceed through the entry formalities and claim your luggage. An F&V Transport Representative holding a RCCL & CC Crewmember Transportation Sign will greet you in the baggage claim terminal. Should you have any questions or concerns please contact F&V Transport at (787)647-4948.

## **Terminal D**

International Flights Terminal (Second Level)

Liat Airlines-American Eagle-Iberia-British Airways-American Airlines-JetBlue Airways

Upon arrival at the airport, please proceed through the Immigration and Customs formalities and claim your luggage. An F&V Transport Representative holding a RCCL & CC Crewmember Transportation Sign will meet you outside the customs area. Should you have any questions or concerns please contact F&V Transport at (787)647-4948.

## **Terminal E**

American Airlines  
Baggage Claim

Upon arrival at the airport, please proceed through the entry formalities and claim your luggage. An F&V Transport Representative holding a RCCL & CC Crewmember Transportation Sign will greet you in the baggage claim terminal. Should you have any questions or concerns please contact F&V Transport at (787)647-4948.

Porterage:	Available but not included. No luggage carts are available.
Bus Loading:	For domestic flights and international flights outside baggage claim areas on terminal B and terminal E on the first level.
Bus Drop-Off:	Departure Area – second level, outside curbside.
Flight Parameters:	<b><u>Arriving Crew</u></b> Earliest Arrival Time : 9:00 AM Latest Arrival Time: 12:00 Midnight  <b><u>Departing Crew</u></b> Earliest Departure Time: 7:30 AM Latest Departure Time: 2:00 PM

**\*\*In case of any flight misconnections or delay our recommendation is the crew member should call RCCL/CC Crew Dept. phone number or F&V Transport phone number in order to arrange transportation services with the new flight itinerary\*\***



# LUIS MUNOZ MARIN INTERNATIONAL AIRPORT

## Terminal B Baggage Claim Area

